



# RUBBER COATED NEO POT MAGNETS

Rubber coated pot magnets are constructed with Neodymium magnet encased in a steel structure & coated with Zn or NiCuNi & a protective rubber coating.

Internal female thread or male threaded stud accommodates standard fasteners & attachments.

Widely used on light mounting, GPS fixing, art & holiday decorations hanging, advertising installation or other device installation.

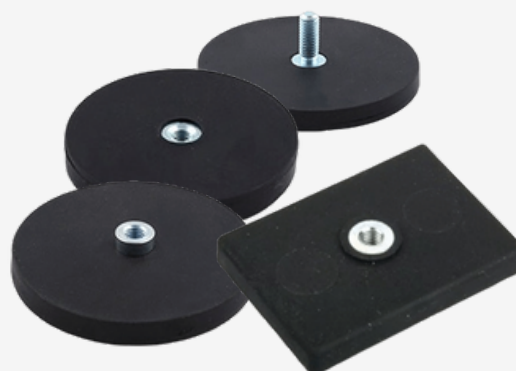

- Bigger friction
- Strong pull force
- Durable & Waterproof
- Scratch protection
- Good corrosion resistant
- Magnets do not easily chip

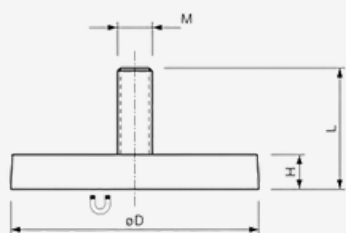

MODEL	DIMENSION (MM)				HOLDING FORCE(KG)
	D	H	L	M(THREAD)	
CMSM-K22	22	5.5	21	M4	6
CMSM-K43	43	6	21	M6	9
CMSM-K66	66	8.5	23.5	M8	20
CMSM-K88	88	8.5	23.5	M8	45

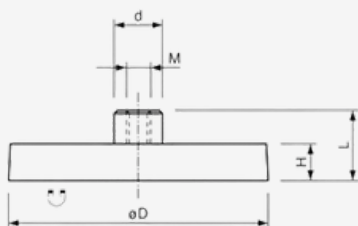

MODEL	DIMENSION (MM)				HOLDING FORCE(KG)
	D	H	L	M(THREAD)	
CMSM-H22	22	6	11.5	M4	4.5
CMSM-H43	43	6	10.5	M4	9
CMSM-H66	66	8.5	15	M5	20
CMSM-H88	88	8.5	17	M6	45

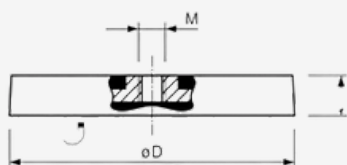

MODEL	DIMENSION (MM)			HOLDING FORCE (KG)	WEIGHT (G)
	D	H	M(THREAD)		
CMSM-G22	22	6	M4	6	12
CMSM-G43	43	6	M4	9	29
CMSM-G66	66	8.5	M6	20	100
CMSM-G88	88	8.5	M6	45	186

## Note:

- Thread material is available in A3 steel or 304 Stainless steel.
- The coating of A3 Steel of thread and neodymium magnet is available in Zinc or NiCuNi.
- The vertical holding force is tested under ideal condition: by tension tester on a 10mm flat steel plate.
- The final holding force needs to be tested in actual application. The test result may be smaller if your steel is thinner, rough, coated or not very flat.
- The rubber pot magnet can be customized on request, including thread type, size, pull force, working temperature.

## China Magnets Source Material Ltd

19 Building, E-TOWN, Henggang St, Longgang District, Shenzhen, Guangdong, China

www.sourcemagnets.com

Email: [sales@china-magnets-source-material.com](mailto:sales@china-magnets-source-material.com)

Tel. No.: (86) 755 - 2817 4720